

Backroom Storage Unit Parts List



(1) 87 3/4" Top Rail



(1) 87 3/4" Bottom Rail

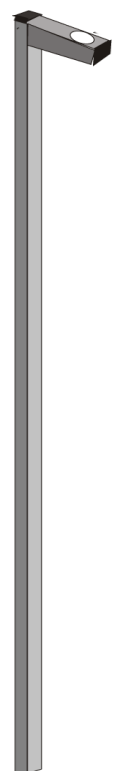

(1) 75" End Post with Hole

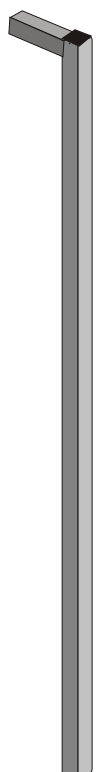

(1) 75" End Post



(1) 75" Connector Post (Optional - Addon)

(8) BSU Hooks

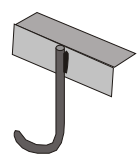

(2) 5-Way Base

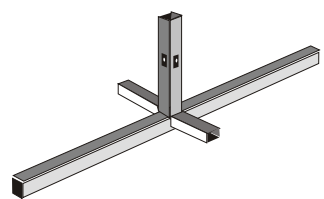

Add-on

- (1) 5-Way Base
- (1) 87 3/4" Top Rail
- (1) 87 3/4" Bottom Rail
- (1) 75" Connector Post (2 Ears)
- (8) BSU Hooks

Hardware:

- 5/16" 1/2" Bolts
- 5/16" x 2" Bolts
- 5/16" Washer
- Nylon Stopnut 5/16"
- 1" Black Plugs
- 1 1/4" Black Plugs
- Rudy Rack Sticker



Backroom Storage Unit

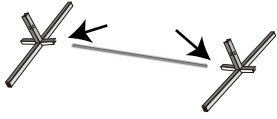

1. Lay out the (2) 5 -Way T-Bases and connect with 87 3/4" Bottom Rail. Tighten using (4) 5/16" x 1/2" Bolts.

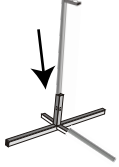

2. Insert the Left and Right End Posts with Ears facing inwards. Tighten using (4) 5/16" x 1/2" bolts.



3. Slide BSU Hooks facing the same way on 87 3/4" Top Rail with through hole facing up and down.

4. Distance hooks to desired spacing and tighten with (1) 5/16" x 1/2" Bolts.

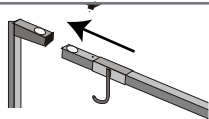

5. Insert 87 3/4" Top Rail with hooks onto Left and Right End Posts. Please note the top rail will have a hole on one end. Keep through holes lined up and connect using (1) 5/16" x 2" Thru Bolt, (2) 5/16" Washers and (1) 5/16" Stopnut.

6. Insert the provided 1" and 1 1/4" Black Plugs into the exposed ends to give the Backroom Storage Unit a finished look.

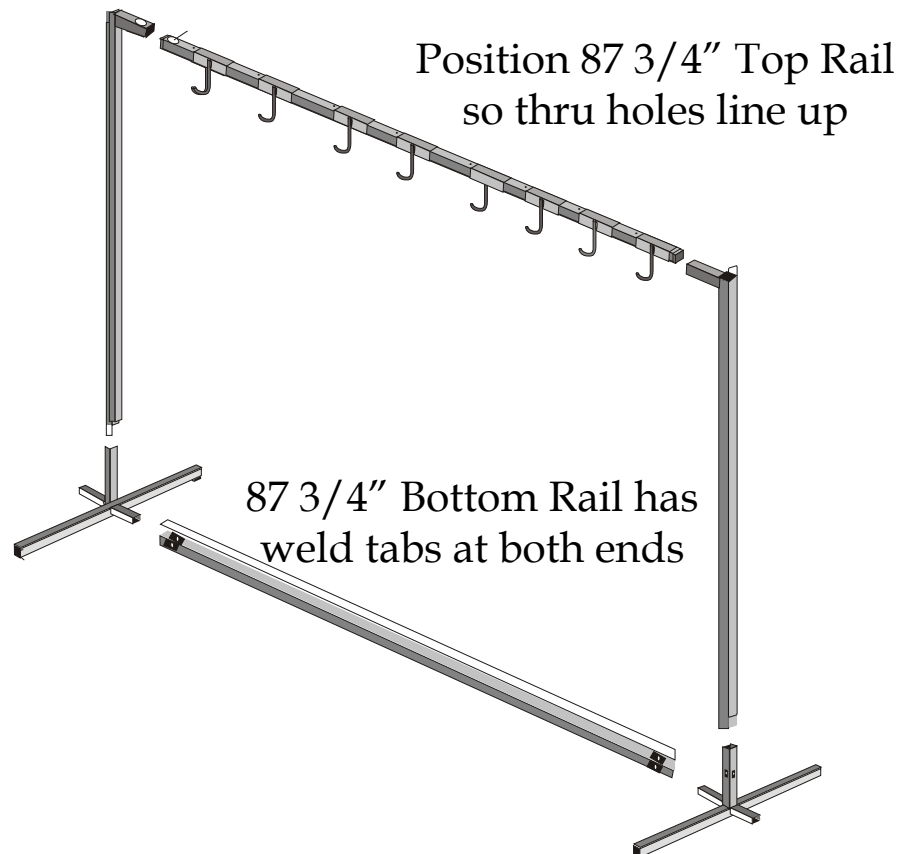

Thank you for your purchase with Rudy Rack.