

SLOPED DOUBLE DECKER - Parts List

2 Tier, Trays On Both

TOP CROSSBAR



BOTTOM CROSSBAR



BOTTOM RAIL



TOP RAIL



52" Front
Corner Post

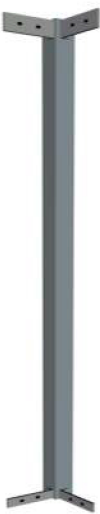

56" Right
Rear Corner

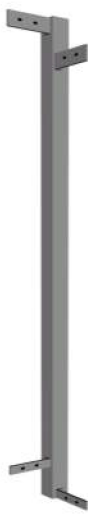

56" Left
Rear Corner

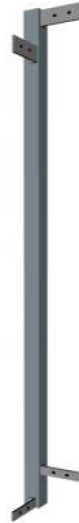

Angled
High Slide

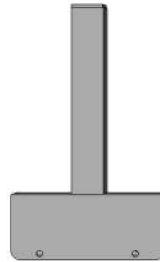

Angled
Low Slide

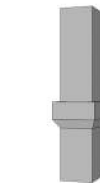
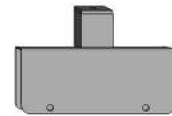

CONDO FOOT



SAFTEY STOP

High Tray

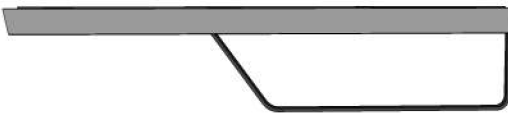

Tray



Stanchion

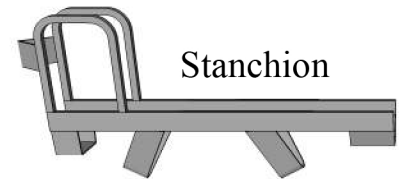

SLIDE SPACING

RAIL LENGTH	FROM END OF RAIL	BETWEEN SLIDES
82"	3 7/8"	7 5/8"
95"	3 3/4"	7 1/2"
108"	3 3/4"	7 1/2"

Hardware:

1/4" x 3/4" Bolts

5/16" x 1/2" Bolts

1/4" x 1 3/4" Bolts

5/16" x 3/4" Bolts

1/4" Stopnut

1" Black Plug

1 1/4" Black Plug

1/2" x 1 1/4" Black Plug

5/16" Washer

1/4" Washer

Super Tray Assembly

Dia. 1

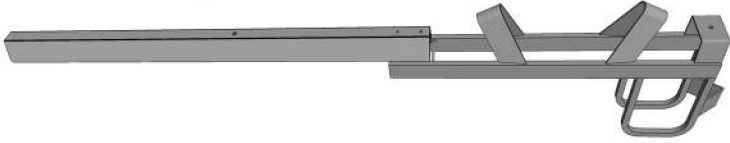

step 1

Flip a stanchion and tray upside down. Align the 2 holes in the stanchion with the 2 holes in the tray. The tray should be on the outside of the stanchion, as shown in Dia. 1.

Dia. 2

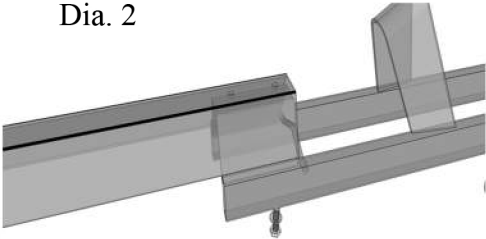

step 2

Place a 1/4" washer over a 1/4" x 3/4" bolt. Insert the assembly through one of the holes, as shown in Dia. 2. Tighten loosely with a 1/4" stopnut.

step 3

Repeat Step #2 in the open hole, as shown in Dia. 3.

Tighten using two wrenches.

Dia. 3

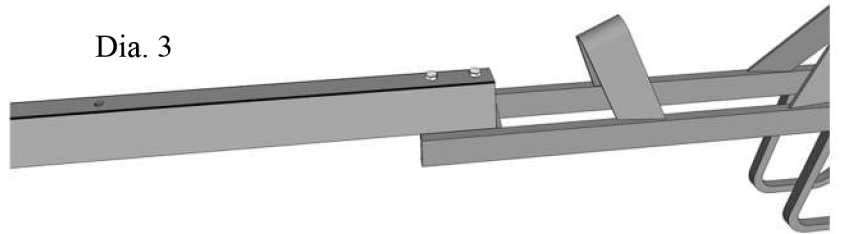

step 4

Insert 2 of the Rectangular Black Plugs in the open holes in the front of the stanchion, as shown in Dia. 4.

Dia. 4

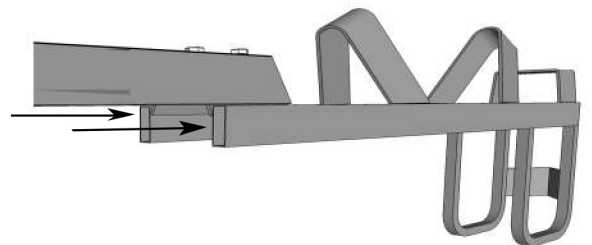

Dia 5

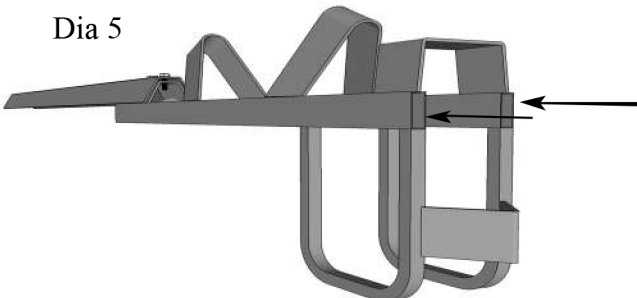

step 5

Insert 2 of the plugs in the back of the stanchion, as shown in Dia. 5. Your tray is now complete!

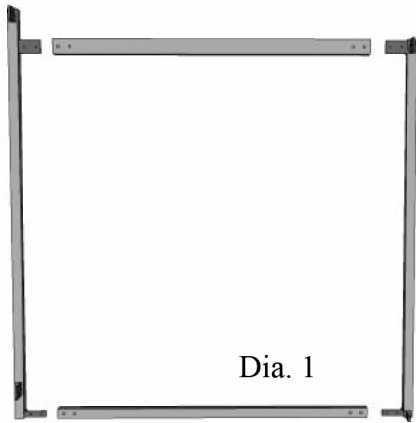

Step 1

Connect one 52" corner post and one 56" corner post with one 43" Top Crossbar and one 43" Bottom Crossbar. Insert the ears on the corner posts into the cross bars, as shown in Dia. 1. Secure using 5/16" x 1/2" bolts and 5/16" washers. You have now completed an end assembly. Repeat this process with the remaining crossbars and corner posts to create the other end of the rack.

Step 2

Locate your two bottom rails. While holding your end assembly upright so the rear corner posts are at the top, slide the ends of the rails over the ears, as shown in Diagram 2. Secure using 5/16" x 1/2" bolts and 5/16" washers. Repeat this step to attach the other end assembly.

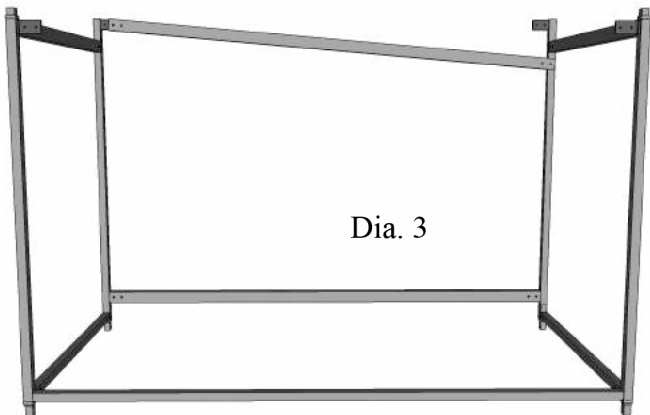
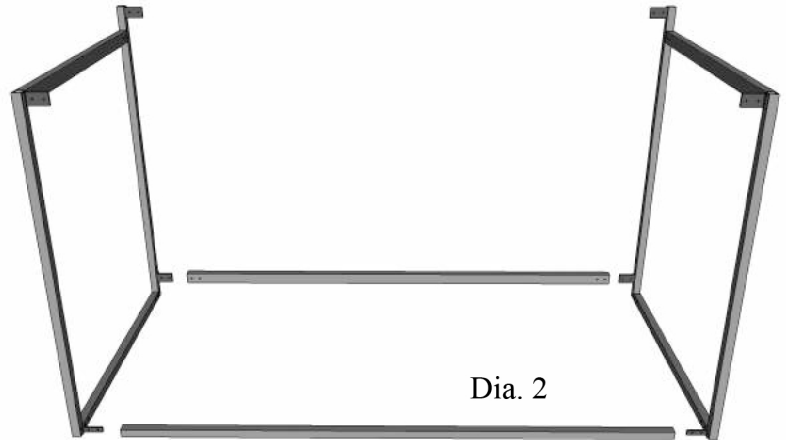

Step 3

Locate a top rail. Slide one end over one of the ears on a corner post. Also, place the other end of the rail over the corresponding ear at the other side of the rack, as shown in Dia. 3. NOTE: it may take a little force to get onto both ears. Secure using 5/16" x 1/2" bolts and 5/16" washers.

Step 4

Repeat step 3 with the remaining top rail. Once again, this may require a little force. Now your structure is complete, as shown in Dia. 4. Some bolts may have loosened during assembly. Tighten.

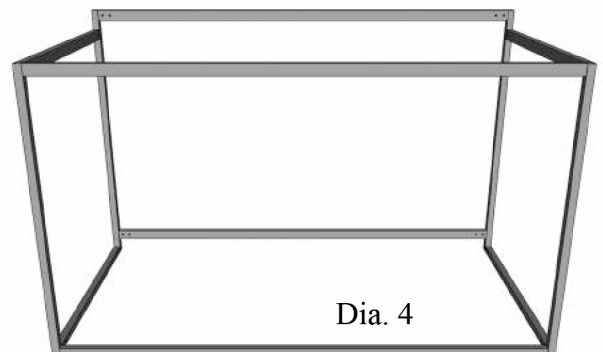

Step 5

Push a 1" Black Plug into each of the condo feet and safety stops, as shown in Dia. 5.
Set the two Safety Stops aside. You will need them later.

Take the four condo feet, go around your structure, lift each corner and slide the long side of each foot into the bottom of each corner post. See Dia. 6.

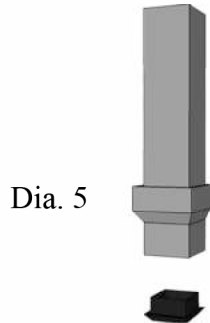

Dia. 5

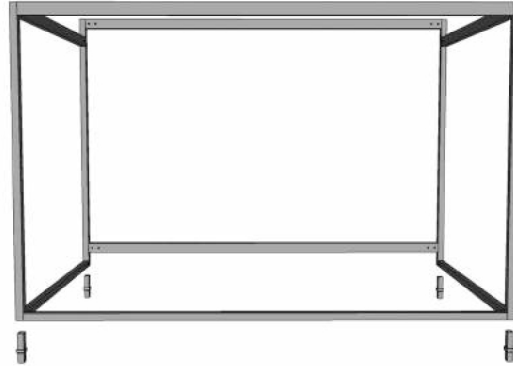

Dia. 6

Step 6

Locate the High and Low Slides. Slide them over the bottom rear rail.
Start at one end and alternate high and low slides, as shown in Dia. 7. You can use the Slide Spacing key on the first page as a guide. Secure using 1/4" x 1 3/4" bolts and 1/4" stopnuts.
Place the slides on the top rear rail so they match the bottom, as shown in Dia. 8

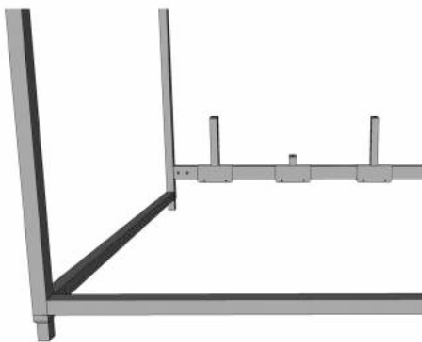

Dia. 7

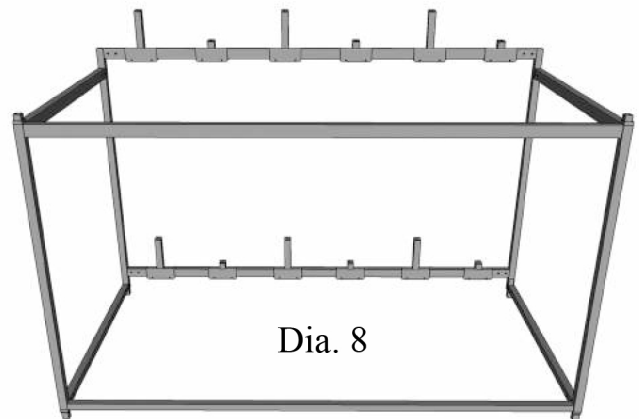

Dia. 8

*Stop! If you haven't already assembled the trays, do so now.
Use the Super Tray Assembly page as your instructions.*

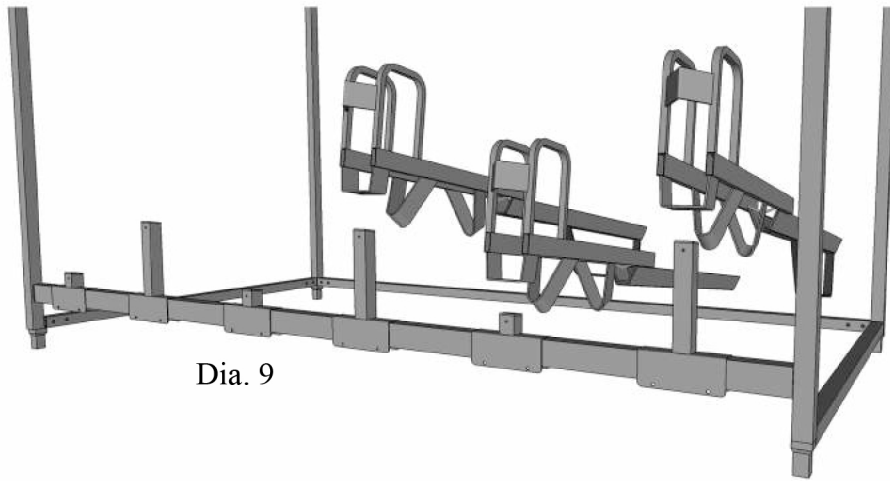

Dia. 9

Step 8.

Take one of the pre-assembled trays (the High Trays should be used with the High Slides, etc.), as shown in Dia. 9.

Align the back hole of the tray with the hole on the slide. Secure using a 5/16" x 1/2" bolt and 5/16" washer. Repeat this process, alternating the trays High and Low.

Step 9

Repeat Step 8 on the Top Rail, as shown in Dia. 10. Finish the rack by placing the 1 1/4" Black Plugs into the rear Corner Posts. Take the two Safety Stops and place those in the front two Corner Posts. This prevents the trays from pivoting off each end.

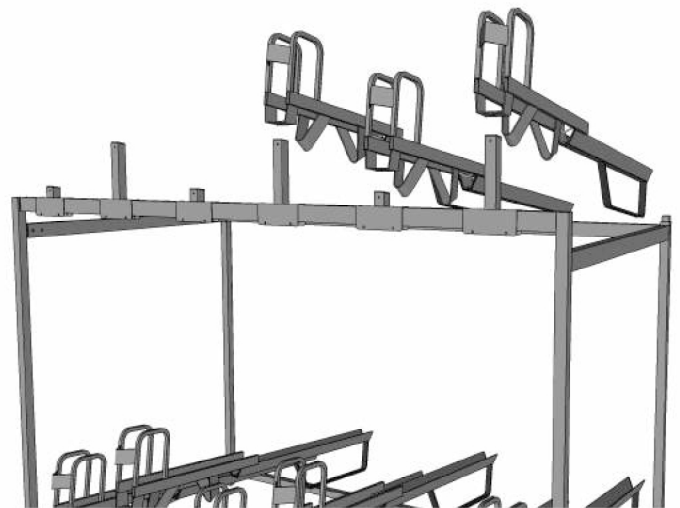

Dia. 10

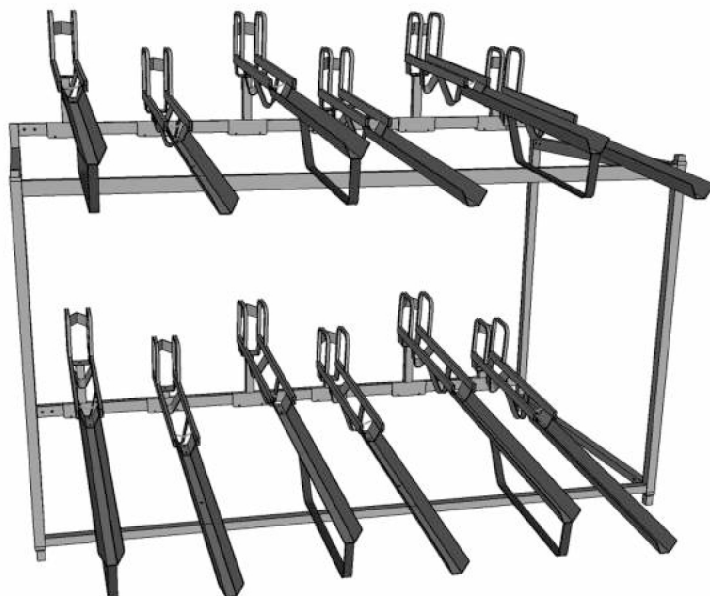

Go back and tighten any bolts that might have loosened. Your Sloped Double Decker is now complete!*

* Before loading bikes onto the rack: If your bike has a rear derailleur, it is recommended that the rear derailleur is set to the lowest gear (the largest rear chain ring) to prevent chain or derailleur damage.