

SLOPED DOUBLE DECKER with Deluxe Space Savers

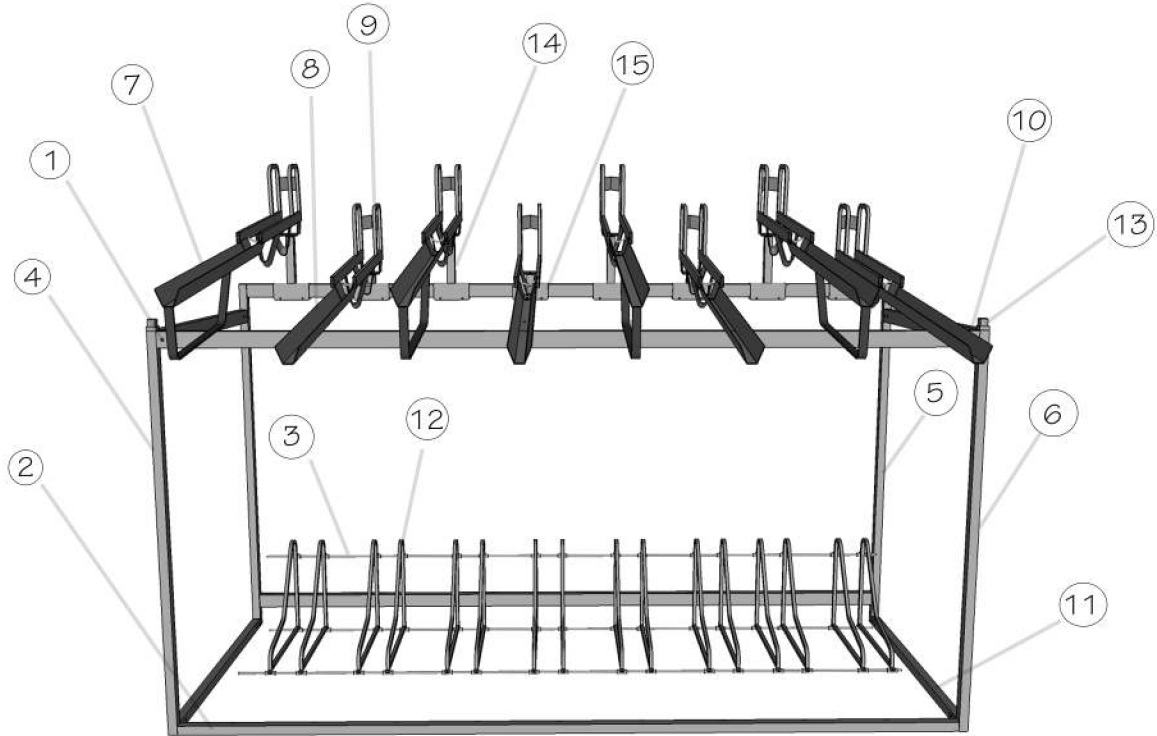

4 LEFT REAR CORNER	5 RIGHT REAR CORNER	6 FRONT CORNER

7 SUPER HIGH TRAY	
8 SUPER LOW TRAY	
9 SUPER STANCHION	
10 TOP CROSS BAR	
11 BOTTOM CROSS BAR	

1 TOP RAIL	
2 BOTTOM RAIL	
3 RUNNER	

12 DELUXE SIDE FRAME	13 SAFETY STOP	14 ANGLED HIGH SLIDE	15 ANGLED LOW SLIDE

HARDWARE

1/4 X 3/4" Bolts
5/16 X 1/2" Bolts
1/4 x 1-3/4" Bolts
5/16 x 3/4" Bolts
5/16" Washers
1/4" Washers
1/4" Stopnuts
1/4" x 3/8" Setscrews
1-1/4" Plugs
1/2 x 1-1/2" Rectangle Plugs

ASSEMBLY INSTRUCTIONS

Step One

Flip a stanchion and tray upside down. Align the 2 holes in the stanchion with the 2 holes in the tray. The tray should be on the outside of the stanchion, as shown in Diagram. 1.

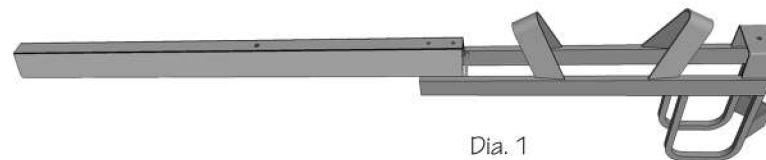

Dia. 1

Step Two

Place a 1/4" washer over a 1/4" x 3/4" bolt. Insert the assembly through one of the holes from the bottom, as shown in Diagram 2. Tighten loosely with a 1/4" stopnut.

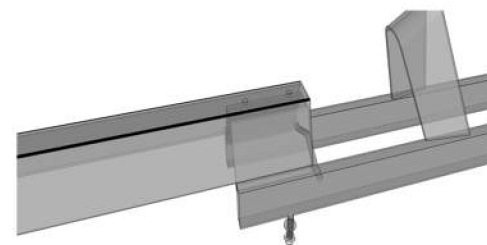

Dia. 2

Step Three

Repeat Step #2 in the open hole, as shown in Diagram 3. Tighten using two wrenches.

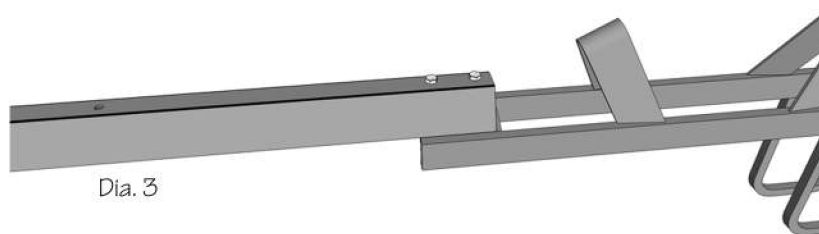

Dia. 3

Step Four

Insert 2 of the Rectangular Black Plugs in the open holes in the front of the stanchion, as shown in Diagram 4.

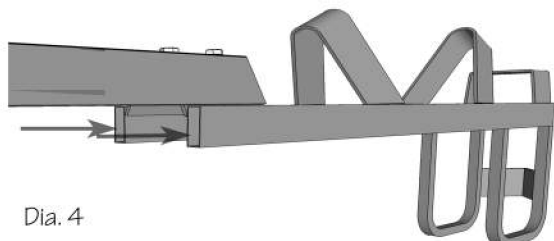

Dia. 4

Step Five

Insert 2 of the plugs in the back of the stanchion, as shown in Diagram. 5. Your tray is now completed. Repeat these steps on the remaining trays.

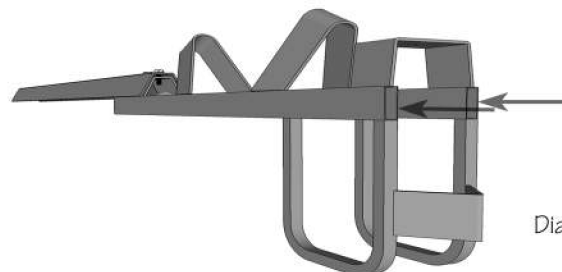

Dia. 5

ASSEMBLY INSTRUCTIONS

Step SIX

Connect One 52" Front Corner Post and One 56" Right Rear Corner Post with one 43" Top Crossbar and one 43" Bottom Crossbar. Insert the ears on the Corner Posts into the Cross Bars, as shown in Diagram 6. The Right Rear Corner will be taller than the front and it's tallest "ear" should be pointed inward. Secure using 5/16" x 1/2" bolts and 5/16" washers.

Repeat this process with the remaining Crossbars and Left Corner Post to create the other end of the rack.

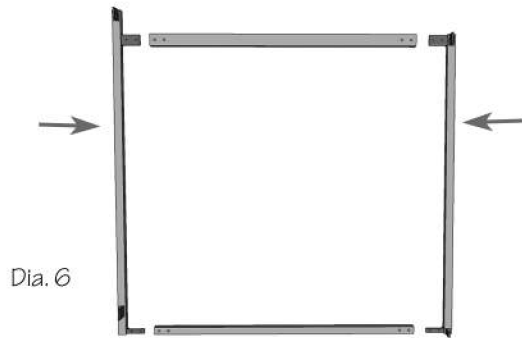

Dia. 6

Step SEVEN

Locate the ONE Bottom Rail and ONE of the "Top" Rails. While holding your end assembly upright so the Rear Corner Posts are in the back, slide the ends of the Rails over the ears, as shown in Diagram 7. The "TOP" Rail should be used in the back of the structure while the "bottom" rail is in the front.

Secure using 5/16" x 1/2" bolts and 5/16" Washers.

Repeat this step to attach the other end assembly.

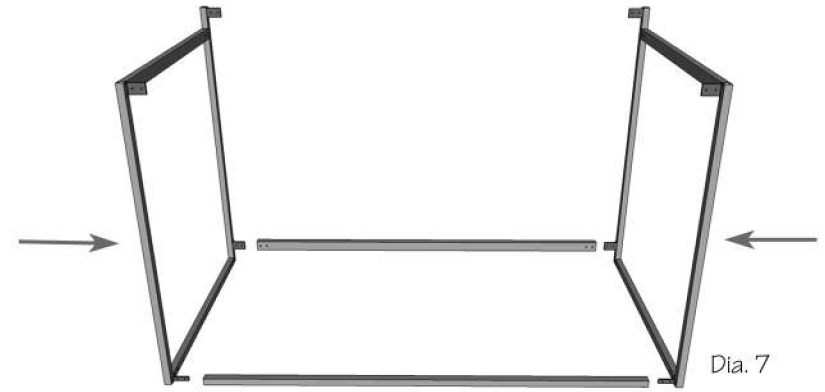

Dia. 7

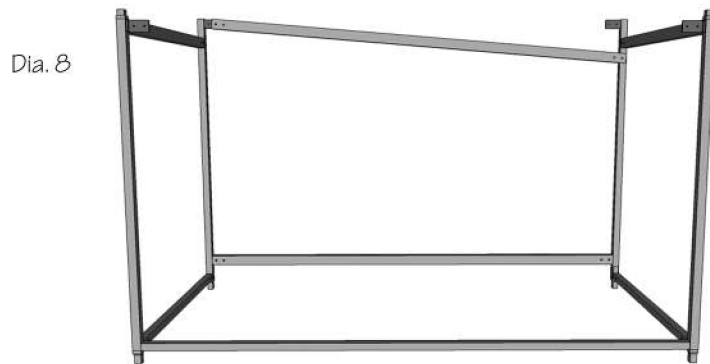

Dia. 8

Step EIGHT

Locate another Top Rail. Slide one end over one of the ears on a Corner Post. Also, place the other end of the rail over the corresponding ear at the other side of the rack, as shown in Diagram 8. NOTE: it may take a little force to get onto both ears.

Secure using 5/16" x 1/2" Bolts and 5/16" Washers.

Step NINE

Repeat Step 8 with the remaining Top Rail. Once again, this may require a little force. Now your structure is complete, as shown in Diagram 9. Tighten any loose bolts.

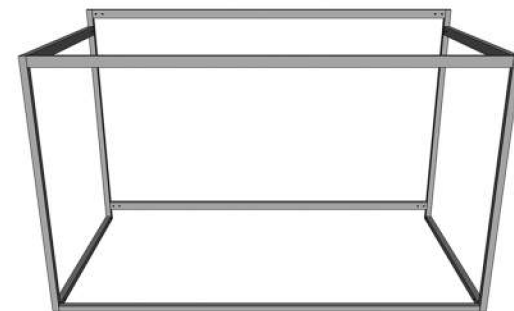

Dia. 9

ASSEMBLY INSTRUCTIONS

Step TEN

Locate the High and Low Slides. Slide them over the Top Rear Rail: start at one end and alternate high and low slides, as shown in Diagram 10. Secure using 1/4" x 1 3/4" bolts and 1/4" stopnuts.

Dia. 10

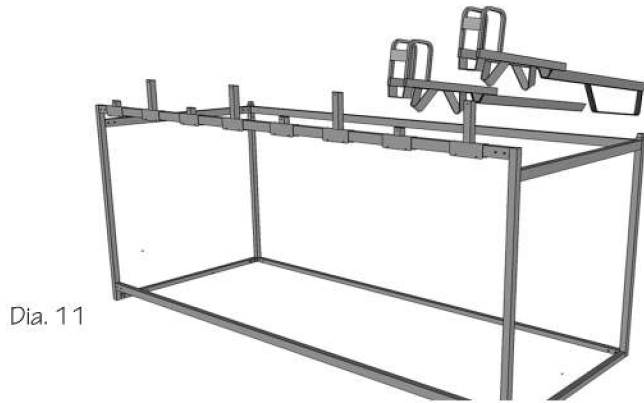
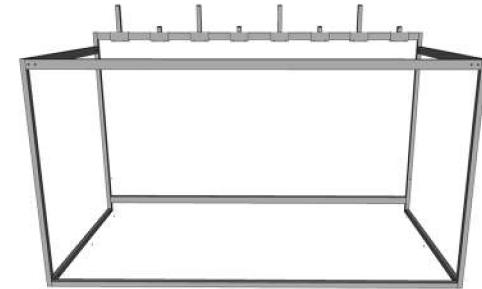

Dia. 11

Step ELEVEN.

Take one of the pre-assembled trays (the High Trays should be used with the High Slides, etc.). Align the hole in the back of the tray with the hole on the slide, as shown in Diagram 11. Secure using a 5/16" x 1/2" bolt and a 5/16" washer. Repeat this process, alternating the trays High and low, until all of the trays have been used.

Step TWELVE

Push a 1" Black Plug into each of the Safety Stops, as shown in Diagram 12A. Insert the Safety Stop into each of the Front Corner Posts, as shown in Diagram 12B, with the plugs facing up. The Safety Stops prevent the trays from pivoting off the rack.



Dia. 12A

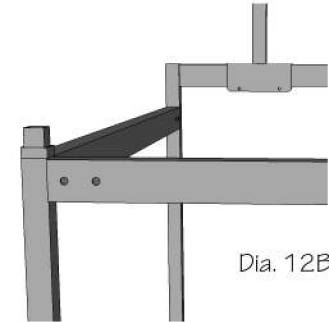

Dia. 12B



Dia. 13 (top view)

Step THIRTEEN

Now, it's time to build the Deluxe Space Savers for the floor. Locate (2) of the Runners. Lay them out on the floor with roughly 18" between them, as shown in Diagram 13.

Step FOURTEEN.

Take one of the side frames and slide the runners into the bottom, as shown in Diagram 14. Slide the side frame about 2 feet from the end and secure using 5/16" x 3/8" Setscrews. This will help prevent the runners from moving while sliding the remaining side frames on.

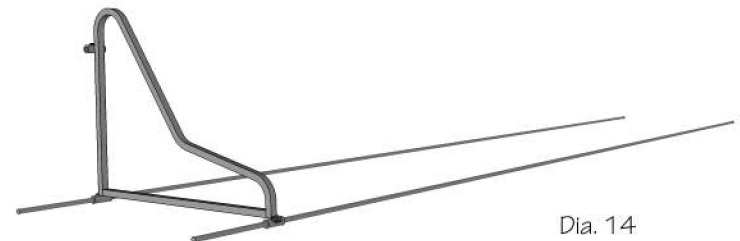

Dia. 14

ASSEMBLY INSTRUCTIONS

Step FIFTEEN

Take the remaining Side Frames and slide them onto the runners, as shown in Diagram 15. Stack them together but DO NOT SECURE them in place. The spacing will be adjusted later.



Dia. 15



Dia. 16

Step SIXTEEN

Take the remaining RUNNER and slide through the tubes in the back of the side frames, as shown in Diagram 16.

Step SEVENTEEN

Set the LAST SIDE FRAME. Slide one frame to the end of the runners and secure in place using (3) 5/16" x 3/8" Set Screws.

Now set the rest of the frames in your desired spacing, as shown in Diagram 17. Set the spacing between frames 1 and 2 for the desired width of the bike tire you'll be displaying. Then, set the spacing between frames 2 and 3 for the distance between each bike. Secure with the 5/16" x 3/8" Set Screws to keep the runners and side frames from moving during assembly.



Dia. 17

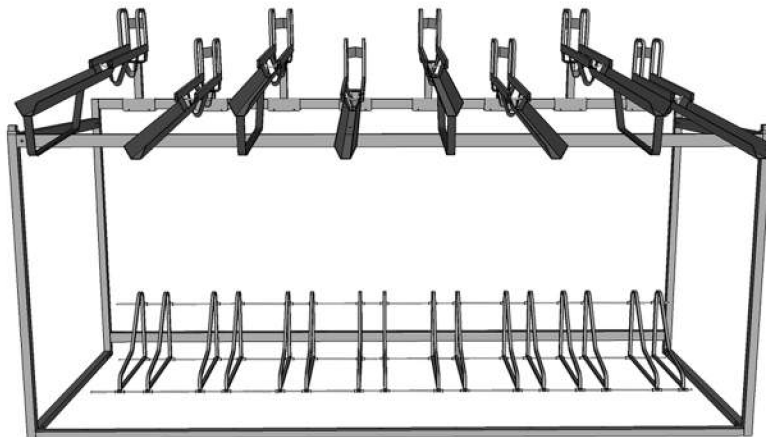

Dia. 18

Step EIGHTEEN

Place the finished Deluxe Space Saver rack under the assembled Sloped Double Decker, as shown in Diagram 18. Your Sloped Double Decker is now complete! *

*Before loading bikes onto the rack: If your bike has a rear derailleur, it is recommended that the rear derailleur is set to the lowest gear (the largest rear chain ring) to prevent chain or derailleur damage.