

WDD 3RD TIER ADD-ON SECTION

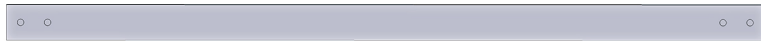

Top Crossbar



3rd Tier Connector Post

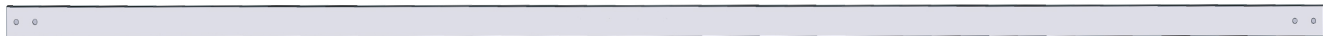

Top Rail

STEP ONE: After your 2-Tier Frame is built, add your 3rd Tier before attaching Slides and Trays.



STEP TWO: Insert the (4) 3rd Tier Connector Posts into the top of the four Corner Posts.

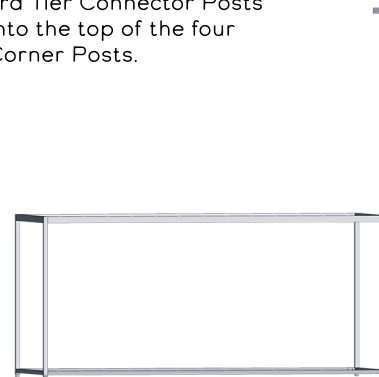

STEP THREE: Slide the Top Crossbars onto the ears of the Connector Posts, as shown. Secure with 5/16" x 1/2" Bolts and 5/16" Washers.

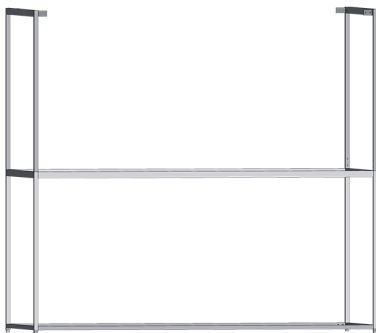

STEP FOUR: Repeating previous steps for attaching the Front & Rear Top Rails, secure the Top Rails with 5/16" x 1/2" Bolts and 5/16" Washers.

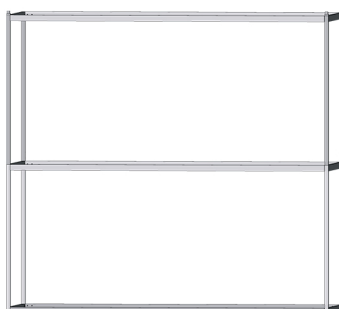
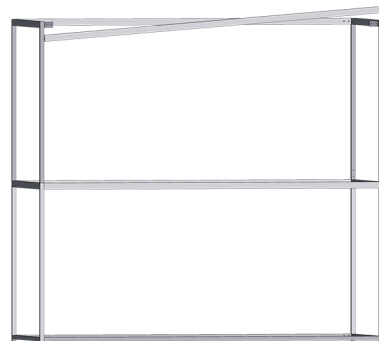

Your 3rd Tier Add-On is Complete!

