

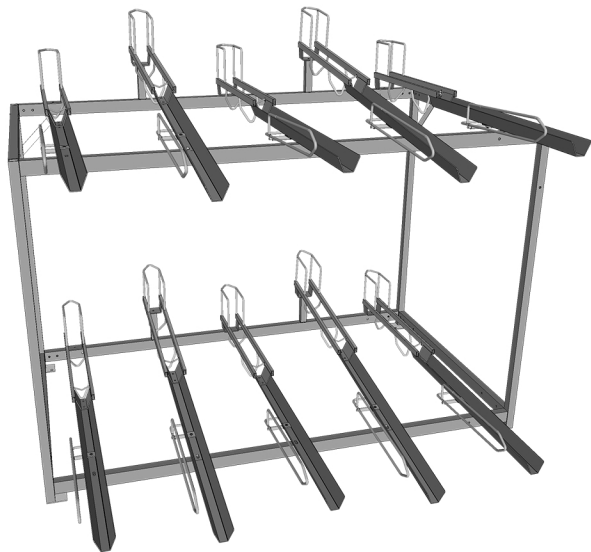

Double Decker

Recommended Team Members Needed: 1

Designed & Made in the
USA



Corner Support
Bracket



Riser



Concrete Anchor



Stanchion

Optional Items



Locking Arm



Locking
Arm Bolt

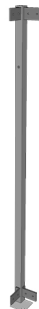

Corner Post



Tray



Crossbar



Rail



Tools

Measuring Tape

(2) 7/16" Wrenches

(2) 1/2" Wrench

Hardware & Parts

Corner Posts

5/16" Washers

Crossbar

Rails

5/16 x 1/2" Bolts

Crossbar

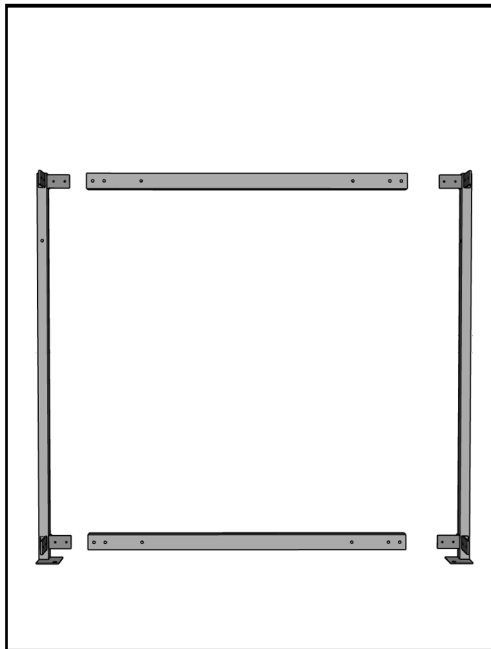

Locate 2 **Corner Posts** and 2 **Crossbars**. Place the parts on a flat surface, insert ears on the **Corner Post** into the ends of the **Crossbars** *loosely* securing with 5/16 x 1/2 "Bolts with 5/16" Washers on them.

Build one more end assembly using the remaining posts and crossbars.

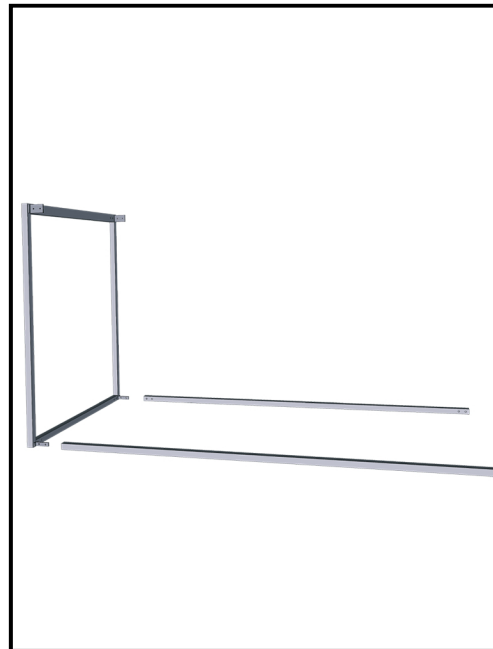

Locate 2 **Rails**. Prop up or ask someone to hold up the end assembly you just made as you slide the Bottom Rails into place. *Loosely* secure the Bottom Rails to the end assembly with 5/16 x 1/2" Bolts with 5/16" Washers on them. Do the same with the other end assembly.

Thank the person who helped, and let's continue!



Hardware & Parts

Rails

5/16 x 1/2" Bolts

5/16" Washers

1-1/4" Black Plug

Corner Support Brackets

5/16 x 2" Bolt

5/16" Stopnuts



Locate the 2 **Rails**. Connect them to the to the upper corner ears of the end assembly using the same process that you use for the bottom rails. **Loosely** secure them using 2, 5/16 x 1/2" Bolts with 5/16" Washers on them.

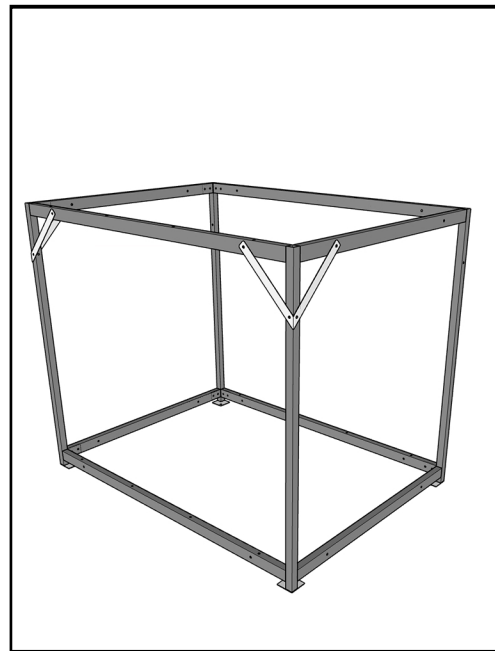

Loosely secure the **Corner Support Brackets** on the top rear of the frame using a 5/16 x 2" bolt, 2 5/16" Washers (one on the outside one on the inside) and a 5/16" Nut.

Move the rack to the place where it will stay. Making sure that the Corner Support Brackets are on the back side. **Tighten all the bolts on the entire frame.**

Place the 4 **Black Plugs** in the open holes on the top of the corner posts.



Hardware & Parts

Riser

5/16 x 2-3/4" Bolt

5/16 Washer

1/4 x 3/4" Bolt

1/4" Washer

1/4" Stopnut

Stanchion

Tray

1/2 x 1" Black Plug

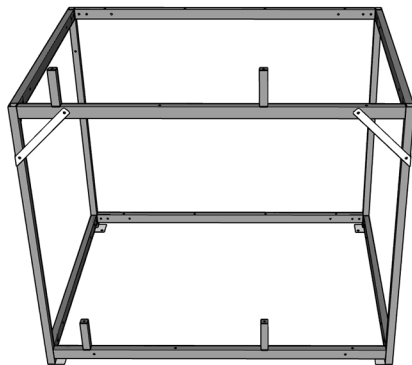

Top View from Back

Find the Riser. On the back side of the frame, install the Risers on every other hole on the top and bottom rear Rails. Do this using a **5/16 x 2-3/4" Bolt** and **5/16" Washer**.

Make sure that when the bolt is tight that the sloped top of the risers is facing toward the front of the rack.

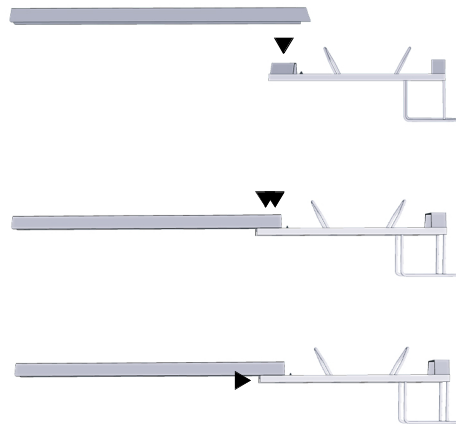

Locate the **Tray** and **Stanchion**. Flip the Stanchion upside down and place the Tray on top, aligning the two holes.

Insert a **1/4 x 3/4" Bolt** with a **1/4" Washer** through the bottom of the holes and tighten with **1/4" Washer** and **Stop nut**.

Insert **1/2 x 1" Plugs** into the open holes in the front of the Stanchion.



Hardware & Parts

Lock Arm Bolt

Lock Arm

5/16 x 3/4" Bolts

5/16" Washer

1 x 1/2" Black Plugs

Rubber Washer

5/16" Stopnuts

5/16 x 2-3/4" Bolt

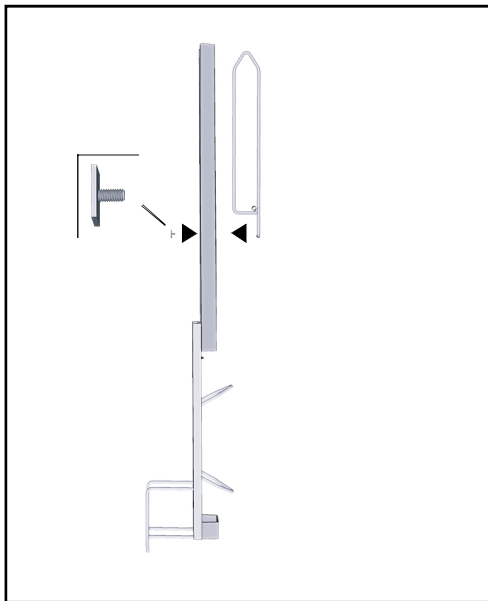

Skip this step if you DO NOT have Lock Arms

Unscrew the **Lock Arm Bolt** from the **Lock Arm**. Place it through the circular hole from the inside of the Tray on the Tray assembly. Slide a Rubber Washer on it.

Take the Locking Arm and rotate it clockwise on the Locking Arm Bolt until snug. **DO NOT OVER TIGHTEN.**

Pro Tip: I like to hold the tray assembly vertically for this step while others like it laying upside down.

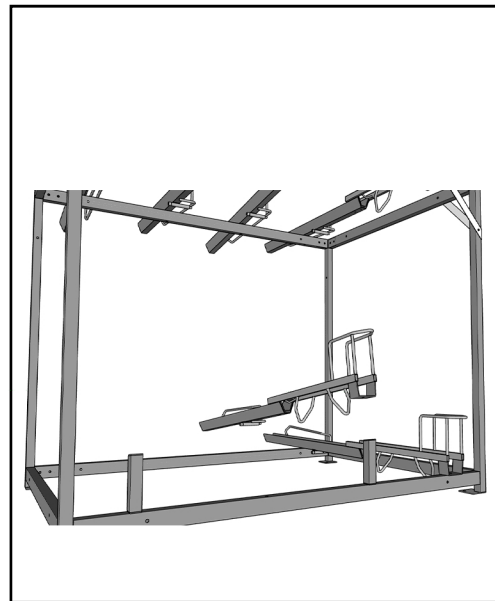

Starting on the Bottom Rail attach each Tray Assembly to the Riser with **5/16 x 3/4" Bolts** with **5/16" Washers**. Then the front of the Tray using **5/16 x 2-3/4" Bolts**, **2 5/16" Washers**, and a **5/16" Nut**.

Repeat this process to complete the Top and Bottom Rail.



Hardware & Parts

Concrete Anchor

Wow, look at that thing! You did a fantastic job!

We and other Rudy Rack customers would love you to see your new Rudy Rack in the WILD! Tag us in a post at **@Rudyrackwis** and show everyone why you went with Rudy Rack.

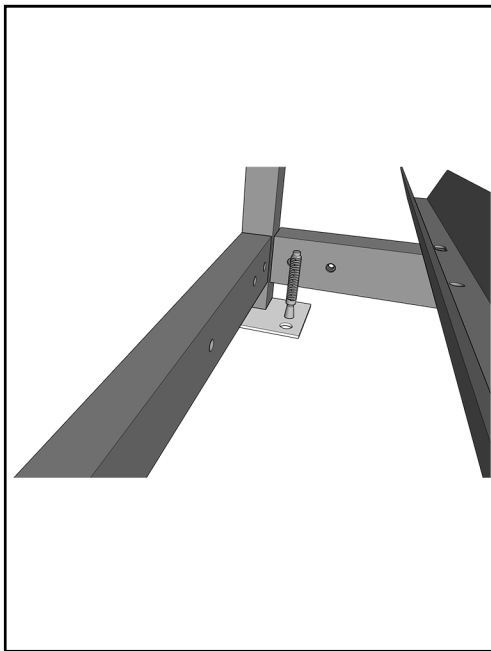

We recomend using the 4 supplied **Concrete Anchors** to secure this tank of a rack to the concrete floor.