

# WALL DOUBLE DECKER - PARTS LIST

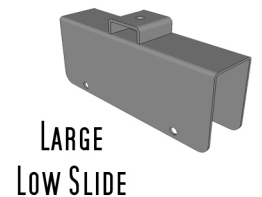
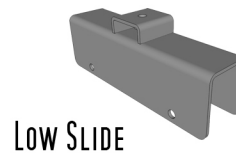
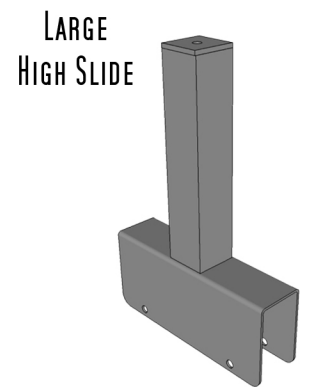
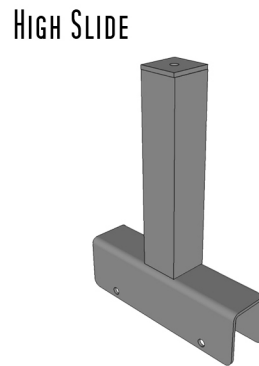
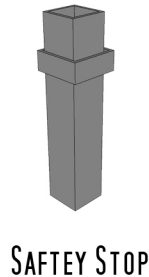
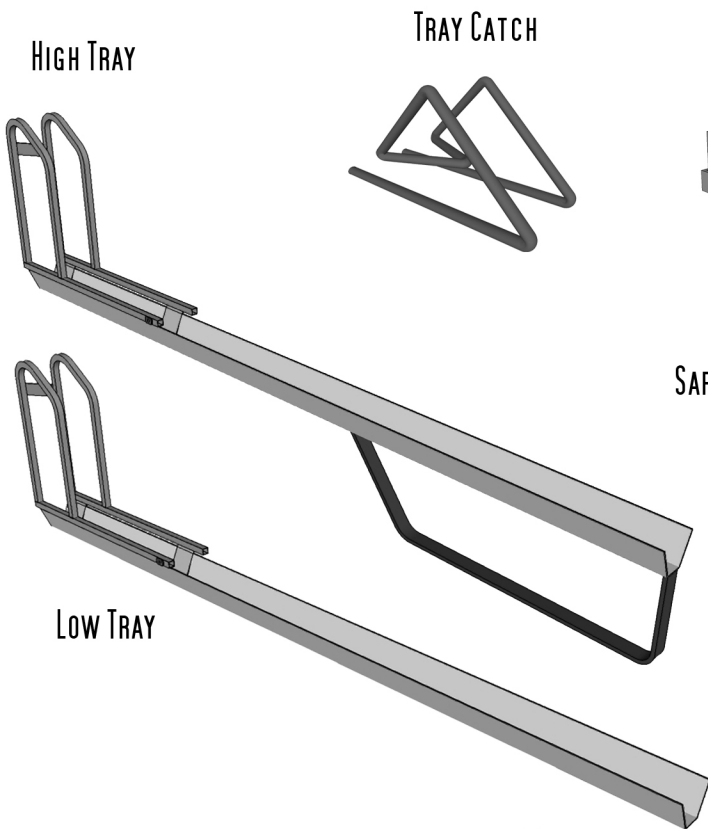
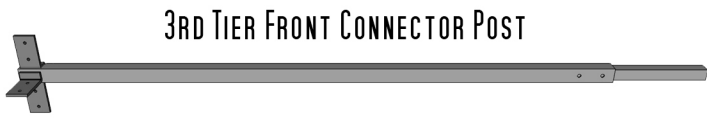

## HARDWARE:

- 5/16" x 1/2" BOLTS
- 5/16" x 3/4" BOLTS
- 5/16" WASHERS
- 5/16" NYLON STOPNUTS

- 1/4" x 3/8" SETSCREWS
- 1/2" BLACK PLUGS
- 1" BLACK PLUGS
- 1/4" BLACK PLUGS
- RUDY RACK STICKER

RAIL LENGTH	SLIDE SPACING	
	FROM END OF RAIL	BETWEEN SLIDES
82"	3 7/8"	7 5/8"
95"	3 3/4"	7 1/2"
108"	3 3/4"	7 1/2"

# WDD - ASSEMBLY INSTRUCTIONS

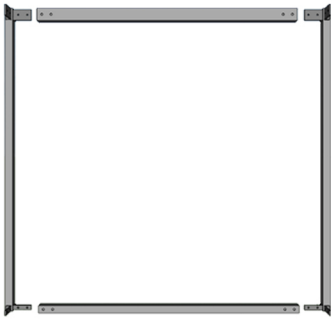

1.  
LOCATE TWO CORNER POSTS AND ONE BOTTOM CROSS BAR AND ONE TOP CROSSBAR. LAY THE PARTS ON A FLAT SURFACE INSERTING THE EARS ON THE CORNER POSTS INTO THE CROSS BARS AS SHOWN IN THE DIAGRAM TO THE LEFT. SECURE USING 5/16" X 1/2" BOLTS AND 5/16" WASHERS, CREATING AN END ASSEMBLY. REPEAT THIS PROCESS AGAIN WITH THE REMAINING CROSSBARS AND CORNERS POSTS TO CREAT E ANOTHER END

2.  
LOCATE YOUR TWO BOTTOM RAILS. WHILE HOLDING YOUR END ASSEMBLY UPRIGHT (SMALL EARS ON THE BOTTOM), SLIDE THE ENDS OF THE RAILS OVER THE EARS AS SHOWN IN THE DIAGRAM TO THE RIGHT. SECURE USING 5/16" X 1/2" BOLTS AND 5/16" WASHERS.

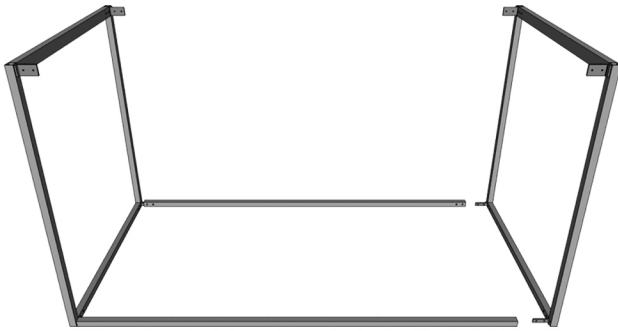

3.  
NEXT YOU WANT TO MIRROR THIS PROCESS USING THE REMAING END ASSEMBLY. SECURE USING 5/16" X 1/2" BOLTS AND 5/16" WASHERS.

4.  
LOCATE A TOP RAIL. SLIDE ONE END OF THE TOP RAIL OVER ONE OF THE EARS ONE THE CORNER POST WHILE NEGOTIATING THE OTHER END OVER THE CORRESPONDING EAR ON THE OTHER END OF THE RACK. NOTE: IT MAY TAKE A LITTLE FORCE TO GET THE ONTO BOTH EARS. SECURE USING 5/16" X 1/2" BOLTS AND 5/16" WASHERS

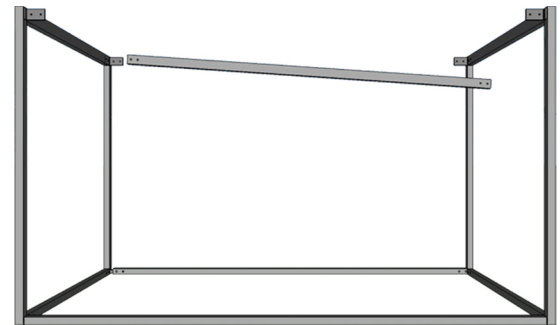

5.  
REPEAT STEP 4 WITH THE REMAINING TOP RAIL.  
NOW YOUR STRUCTURE IS COMPLETE.  
SOME BOLTS MAY HAVE LOOSENED DURING THE ASSEMBLY, GO BACK AND MAKE SURE ALL BOLTS ARE SNUG BEFORE MOVING ON.

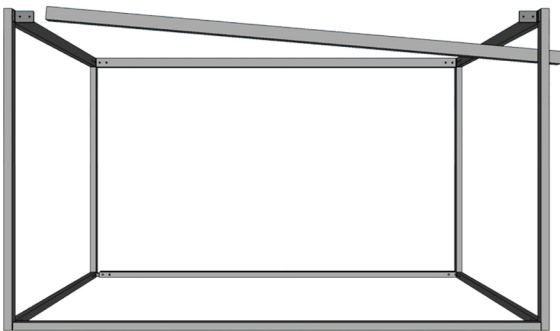

**STOP.**

IF YOUR RACK HAS TRAYS ON BOTH TIERS DO STEP 5A. IF YOUR RACK DOESN'T HAVE TRAYS ON BOTH TIERS SKIP TO STEP 6.

# WDD - ASSEMBLY INSTRUCTIONS

## 5A.

IF YOU HAVE TRAYS ON BOTH TIERS YOU SHOULD HAVE RECEIVED ADDITIONAL SAFTY STOPS AND BLACK 1" PLUGS. PUSH A 1" BLACK PLUG INTO EACH OF THE SAFTY STOPS AS SHOWN TO THE LEFT. ONCE THE SAFTY STOPS HAVE PLUGS IN THEM, GO AROUND YOUR STRUCTURE LIFTING EACH CORNER AND SLIDING THE LONG SIDE OF THE SAFTY STOP INTO THE VERTICAL TUBE OF THE CORNER POSTS AS SHOWN IN THE DIAGRAM ON THE BOTTOM LEAFT.

LOCATE THE SMALL (BOTTOM) SLIDES. SLIDE THEM OVER THE BOTTOM RAIL IN WHAT YOU WANT TO BE THE REAR OF THE RACK. STARTIING AT ONE END WITH A SMALL LOW SLIDE AND ALTERNATING LOW HIGH LOW ALONG THE RAIL AS SHOWN IN THE BOTTOM RIGHT DIAGRAM.. SPACE THE SLIDES ACCORDING TO THE TABLE ON THE BOTTOM OF PAGE 1 (PARTS PAGE) SECURE USING 1/4" X 3/4" BOLTS AAND 1/4" NYLON LOCK NUTS.

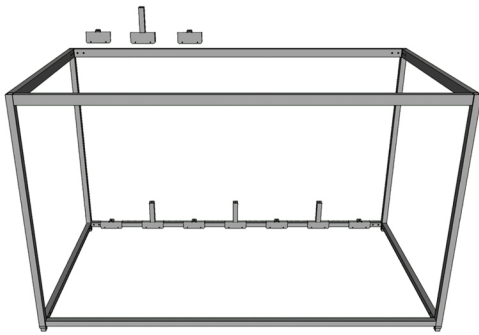
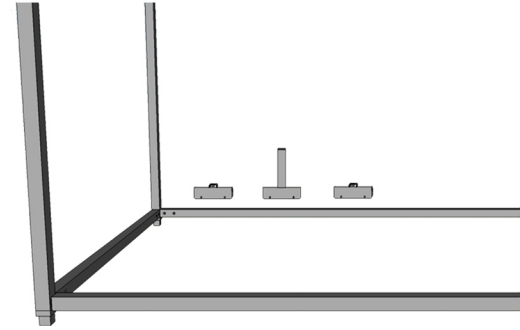
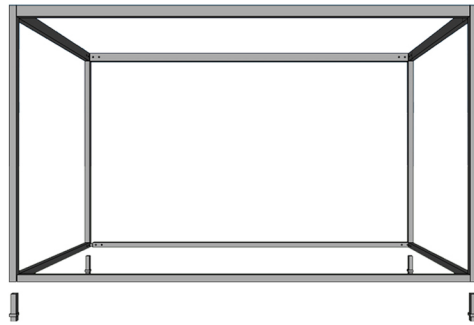
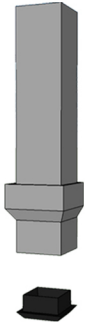

## 6.

LOCATE THE LARGE HIGH AND LOW SLIDES. STARTING FROM THE END ALTERNATING LOW, HIGH, LOW... SLIDE THE SLIDES OVER THE TOP RAIL (SEE DIAGRAM).

## 7.

SPACE THE SLIDES ACCORDING TO THE THE MODEL YOU RECIEVED ON THE TABLE ON PAGE 1 (PARTS PAGE). SECURE USING 1/4" X 3/4" BOLTS AND 1/4" NYLON LOCK NUTS.

YOUR RACK SHOULD NOW RESEMBLE THE DIAGRAM TO THE RIGHT.

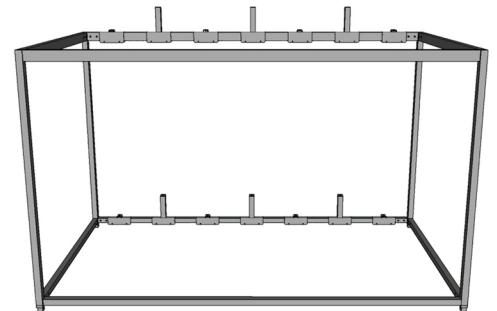

## 7A.

### TRAY SUB-ASSEMBLY

LOCATE: A TRAY, A TRAY CATCH AND A STANCHION. SLIDE THE STANCHION INTO THE TRAY AS SHOWN, ALIGNING THE HOLES. IN THE FRONT HOLE (SEE DIAGRAM) INSERT A 5/16" X 3/4" BOLT THROUGH BOTH THE STANCHION AND TRAY AND SECURE TIGHTLY WITH A 5/16" NYLON STOP NUT. NEXT SLIDE THE ENDS OF THE TRAY CATCH INTO THE ENDS OF THE EXPOSED 1/2" TUBE ON THE FRONT OF THE STANCHION (SEE DIAGRAM), ADJUST TO EDESIED SPACING AND SECURE FINGER TGIHT WITH A 1/4" X 3/8" SET SCREW.



# WDD - ASSEMBLY INSTRUCTIONS

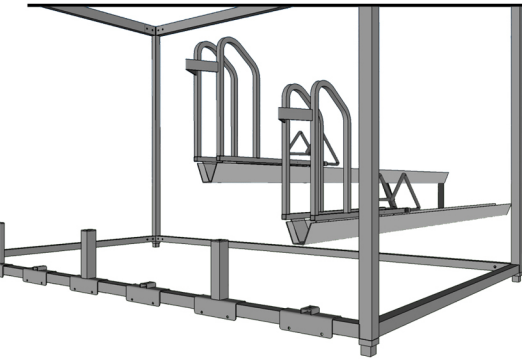

8.

TAKE ONE OF THE TRAYS AND ALIGN THE BACK HOLE ON THE STANCHION WITH THE HOLE ON THE SLIDE AND SECURE USING A 5/16" X 1/2" BOLT. REPEAT THIS PROCESS WITH ALL THE TRAYS ALTERNATING LOW, HIGH, LOW (CORRESPONDING TO THE SLIDE) DOWN THE LENGTH OF THE RAIL. DO THIS FOR BOTH RAILS ON RACKS WITH TRAYS ON BOTH TIERS.

9.

FOR RACKS WITHOUT TRAYS ON BOTH TIERS SKIP TO STEP 10.  
FOR RACKS WITH TRAYS ON BOTH TIERS, YOUR STRUCTURE SHOULD NOW BE COMPLETE. THE LAST STEP IS TO INSERT THE SUPPLIED BLACK PLUGS INTO THE EXPOSED ENDS OF THE TUBE STEEL TO GIVE YOUR RACKING A FINISHED LOOK. YOUR RACK IS NOW COMPLETED.

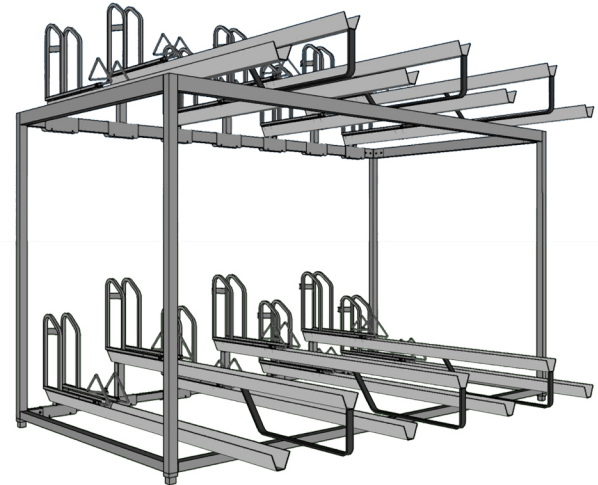

10.

LOCATE AN ADJUSTABLE SPACESAVER AND TWO RUNNERS. SLIDE THE RUNNERS THROUGH THE 1/2" TUBES AT THE BOTTOM OF THE SPACE SAVER AS SHOWN BELOW. REPEAT WITH ALL OF THE SPACE SAVERS, MAKING SURE THE ENDS OF THE RUNNERS ARE EVEN. SPACE THE SPACE SAVERS ALONG THE RUNNERS BASED ON THE TABLE ON PAGE 1 (PARTS PAGE). SECURE THEM USING 1/4" X 3/8" SET SCREWS

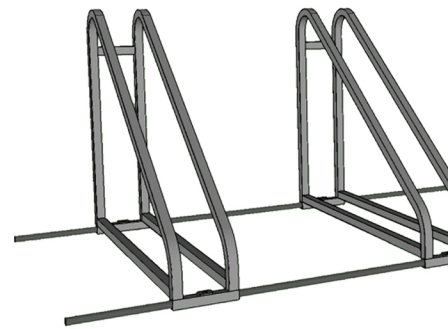
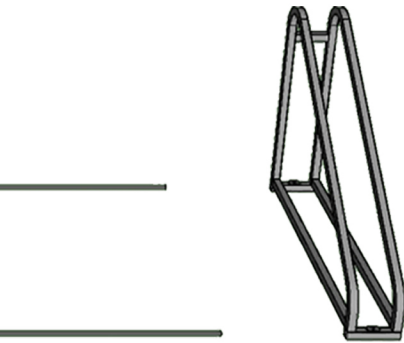

11.

FINALLY TAKE ADJUSTABLE SPACE SAVERS SUB ASSEMBLY AND SLIDE IT UNDER THE RACK AS SHOWN IN THE DIAGRAM TO THE LEFT. YOUR STRUCTURE SHOULD NOW BE COMPLETE. THE LAST STEP IS TO INSERT THE SUPPLIED BLACK PLUGS INTO THE EXPOSED ENDS OF THE TUBE STEEL TO GIVE YOUR RACKING A FINISHED LOOK. YOUR RACK IS NOW COMPLETED.

